

SI-SG3-CR
SI-SG3-CL
SI-SG3-2R
SI-SG3-2L
SI-SG3-3R
SI-SG3-3L

Straight Die Grinder

Straight Disc Grinder

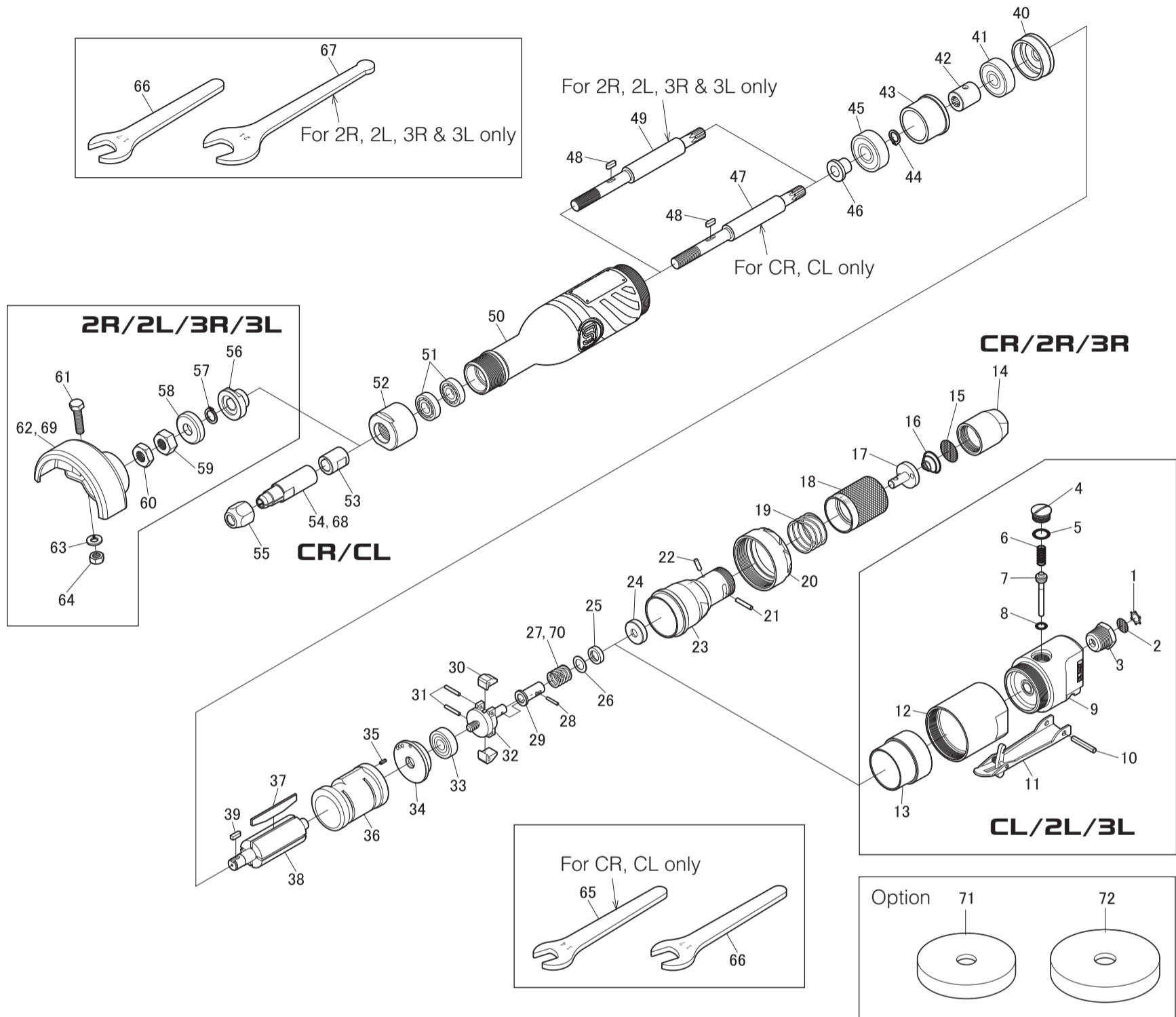

Ref. No.	Parts No.	Description	Q'ty	Ref. No.	Parts No.	Description	Q'ty	Ref. No.	Parts No.	Description	Q'ty
SG3-CL, SG3-2L, SG3-3L				SG3-CR, SG3-CL				COMMON PARTS			
1	CRTW-12	Retainer	1	27	630G-5	Governor Spring	1	25	242-31	Governor Valve Spring Holder	1
2	680-28A	Screen	1	47	630-7	Spindle Shaft	1	26A	242-32A	Shim(0.2mm)	★
3	670-22	Inlet Bushing	1	53	630-3	Spindle Collar	1	26B	242-32B	Shim(0.3mm)	
4	230-68	Valve Screw	1	54	630-2	6mm Collet	1	26C	242-32C	Shim(0.5mm)	
5	P-10	O-Ring	1	55	630-1	Collet Nut	1	28	242-33	Needle Pin	1
6	450-24	Valve Spring	1	65	630-30	Spanner Wrench	1	29	242-29	Governor Valve	1
7	630SIL-6	Valve Pin	1	SG3-2R SG3-2L				30	242-27	Governor Weight	2
8	P-6	O-Ring	1	49	630G-1	Spindle Shaft	1	31	2500-15-8	Needle Roller	2
9	630SIL-4	Valve Housing incl. Governor Collar (630SIL-5) & Bush (280-67)	1	56	630G-2	Disc Receiver	1	32	630-17	Governor Housing	1
10	40-25	Roll Pin(4ø-25mm)	1	57	JS-10	Retaining Ring	1	33	609ZZNSK	Ball Bearing	1
11	242SIL-7	Throttle Lever	1	58	630G-3	Disc Washer	1	34	630-16A	Rear Plate	1
12	630SIL-2	Lock Ring	1	59	N1W3/8-16	Nut	1	35	20-6	Roll Pin(2ø-6mm)	1
13	630SIL-3	Collar	1	60	N3W3/8-16	Nut	1	36	630-15	Cylinder	1
SG3-CR, SG3-2R, SG3-3R				61	W-M60-250	Bolt	1	37	630-13	Rotor Blade	4
14	630-29	Bushing	1	62	630G-4	Disc Cover for ø65mm Grinding Stone	1	38	630-14	Rotor	1
15	2011AC-9	Screen	1	63	HSW-60	Washer	1	39	630-11	Key	1
16	630-28	Valve Spring	1	64	N2-M60	Nut	1	40	630-12A	Front Plate	1
17	630-27	Valve	1	67	630G-6	Spanner Wrench	1	41	6200ZZNSK	Ball Bearing	1
18	630-26	Valve Ring	1	70	630-19	Governor Spring	1	42	630-10	Coupling	1
19	630-25	Valve Spring	1	SG3-3R SG3-3L				43	630-9	Motor Spacer	1
20	630-24	Motor Lock Nut	1	27	630G-5	Governor Spring	1	44	JS-9	Retaining Ring	1
21	3000-16-8	Needle Roller	1	49	630G-1	Spindle Shaft	1	45	6201ZZNSK	Ball Bearing	1
22	502-32	Pin	1	56	630G-2	Disc Receiver	1	46	630-8	Shaft Spacer	1
23	630-23	Governor Case	1	57	JS-10	Retaining Ring	1	48	630-4	Key	1
24	630-22	Governor Bush	1	58	630G-3	Disc Washer	1	50	630SIL-1	Motor Housing	1
				59	N1W3/8-16	Nut	1	51	EE3	Ball Bearing	2
				60	N3W3/8-16	Nut	1	52	630-5	Front Nut	1
				61	W-M60-250	Bolt	1	66	630-31	Spanner Wrench	1
				63	HSW-60	Washer	1	OPTION			
				64	N2-M60	Nut	1	◇ 68	630-2A	1/4 Collet	1
				67	630G-6	Spanner Wrench	1	◆ 71	630-W65	ø65mm × 13mm Grinding Stone	1
				69	630G-8	Disc Cover for ø75mm Grinding Stone	1	□ 72	630-W75	ø75mm × 13mm Grinding Stone	1